



CE PG M K ISO 9001 ISO 14001  
KS

Kiturami



Kiturami

# WORLDPLUS

• WORLDPLUS – 13 / 16 / 20 / 25 / 30

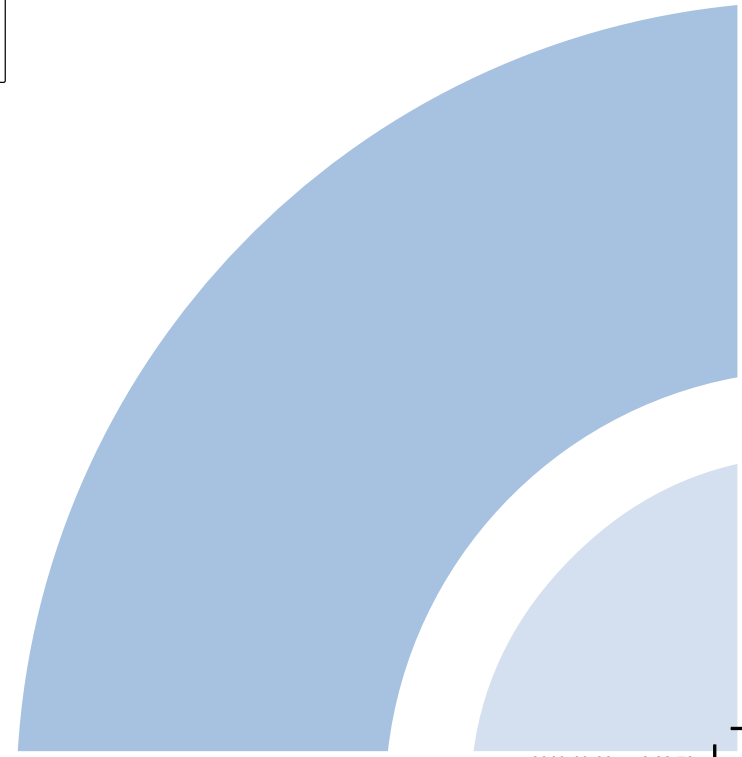
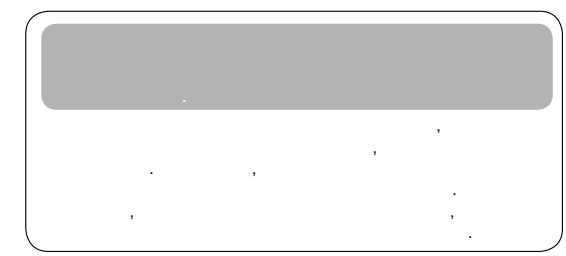
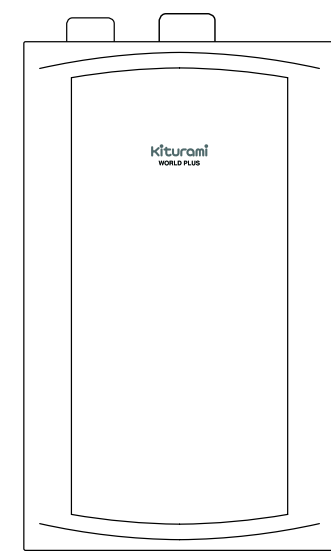



?

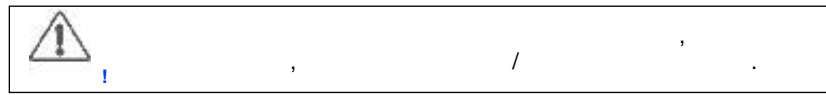

< >

- |     |     |    |
|-----|-----|----|
| 1.  |     | 03 |
| 2.  | < > | 04 |
| 3.  |     | 05 |
| 4.  |     | 08 |
| 5.  |     | 11 |
| 6.  |     | 18 |
| 7.  |     | 22 |
| 8.  |     | 23 |
| 9.  |     | 24 |
| 10. |     | 26 |
| 11. |     | 27 |
| 12. |     | 29 |
| 13. |     | 41 |
| 14. |     | 42 |
| 15. |     | 43 |



< !>, :





« » « » « », « », » ,

. ( . . . 10)

« » ,

. ( . . . 11, 13, 17)

. 24 ~ 25) ( ) . (

. (

. )

. ( . . . 8, 11)

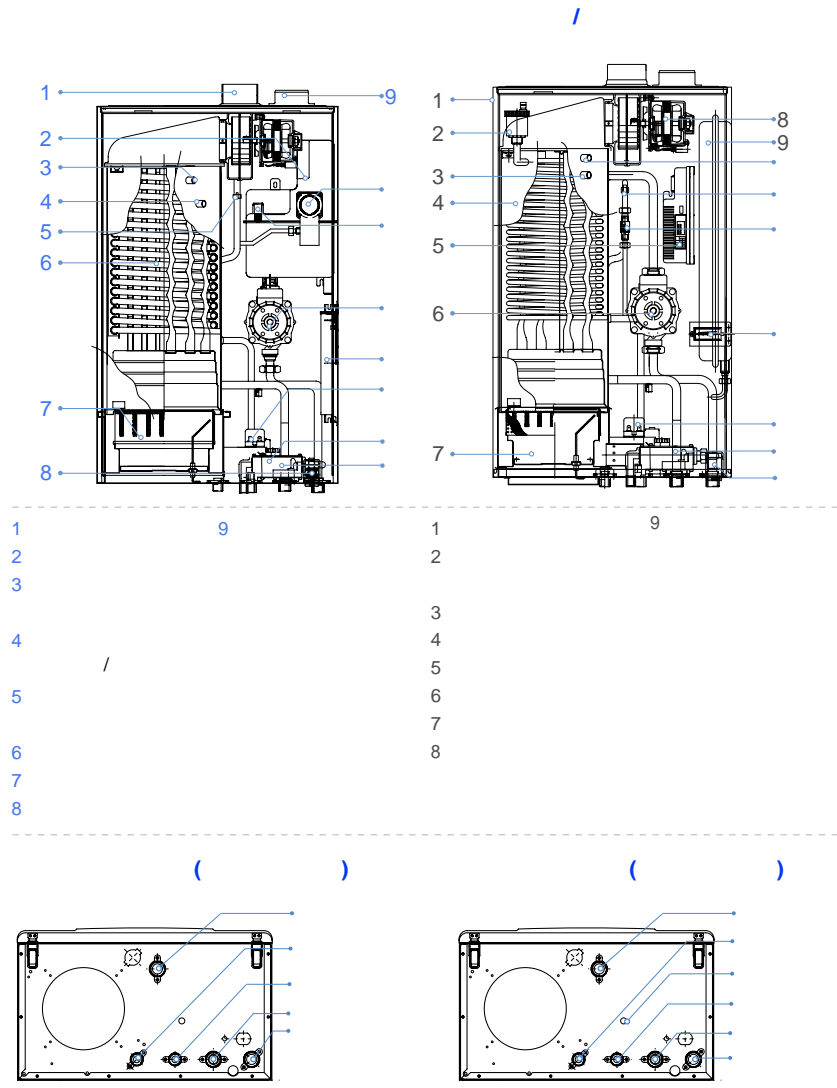



Kiturami

(GTX\_5050N)

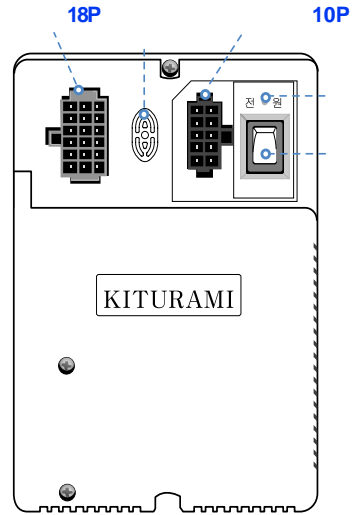
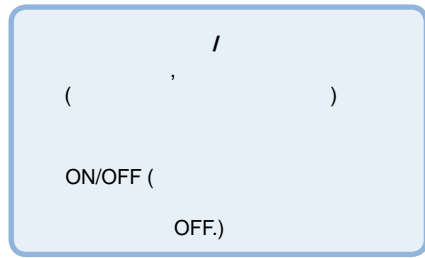

(GTX\_6000)

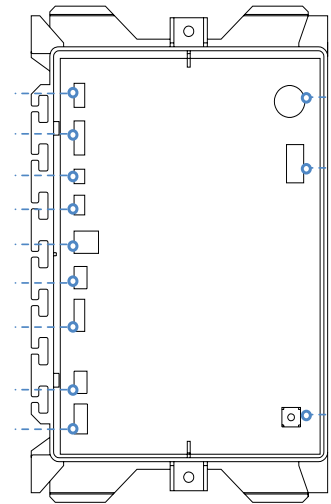
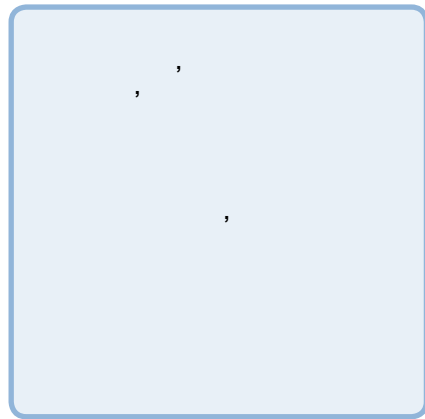

Kiturami

CTR-5700 PLUS

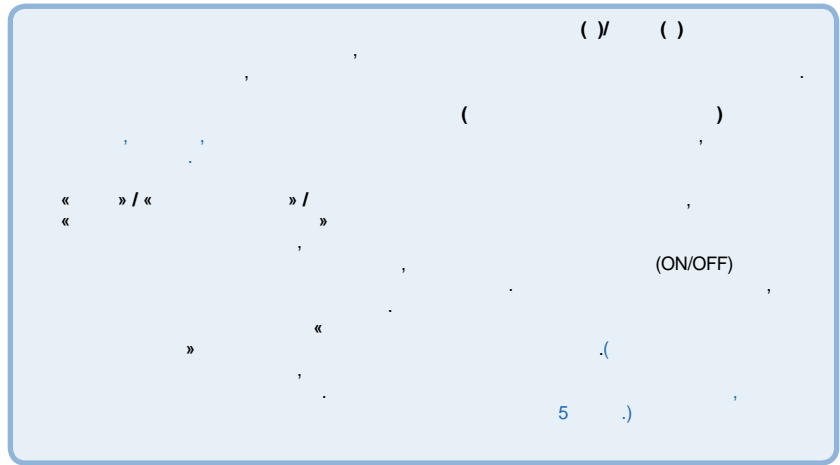
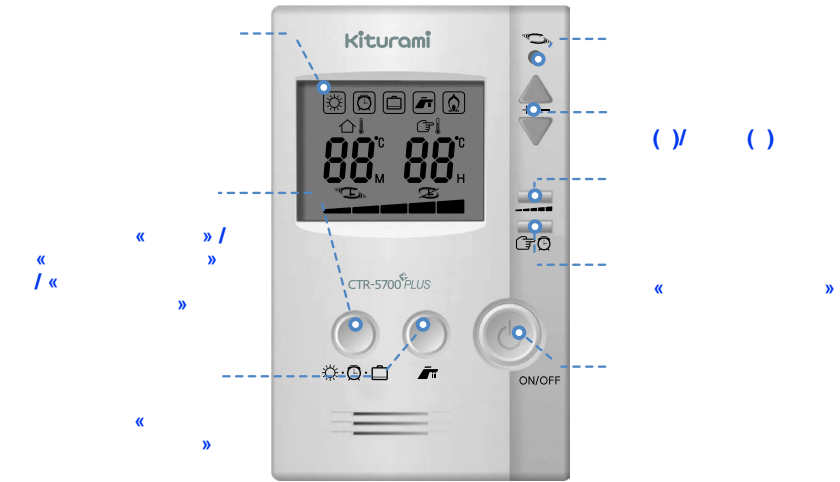



: :

( . )



: :

230 /50

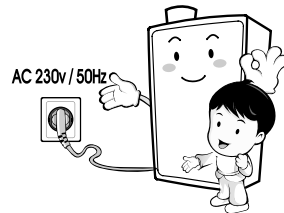

: :

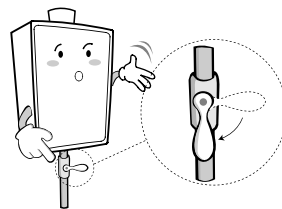

: :

No. 95

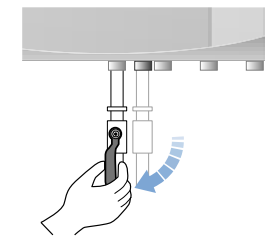

: :

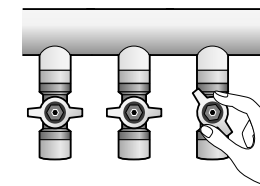

: :

(CO).

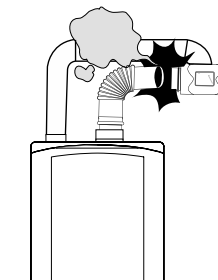



!



(30°C.)



!

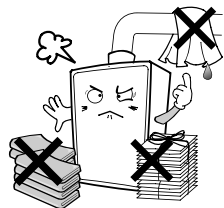

:

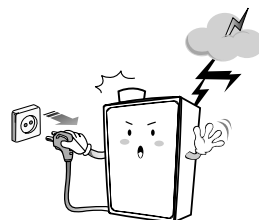

!



:



!



:

- 1.
- 2.
- 3.

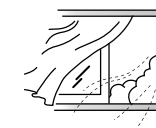

?



!



:



(

?

'97'



:

.( . . .20)



:

“95”



:

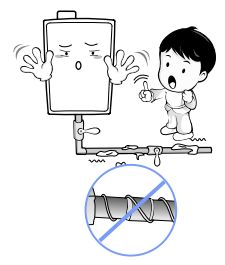

1.

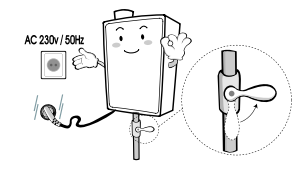

2.

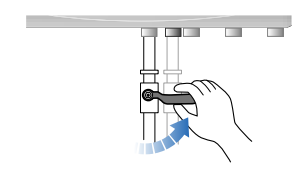

3.

4.

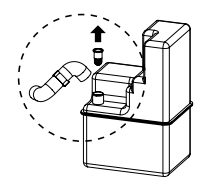

5.

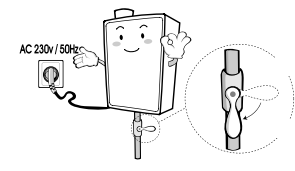



:

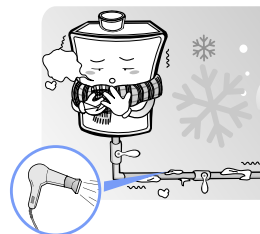

?



:



:

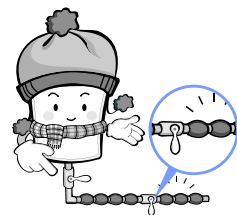

:



:

2-3

2-3

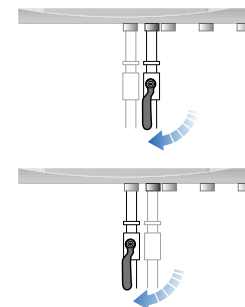

:

?

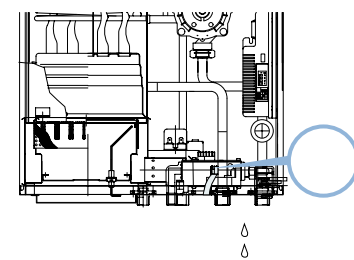

!



:

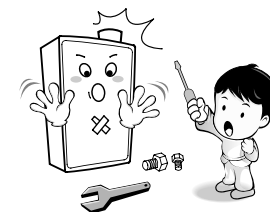





!

: 1



!

: 2

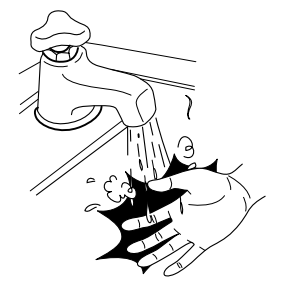

!

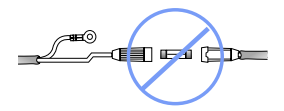

!

1-2

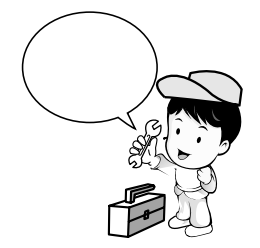

!

( )

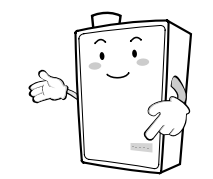

), ( )

(2kgf/cm<sup>2</sup>)





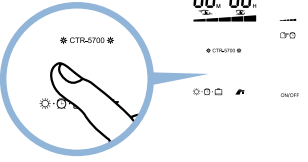

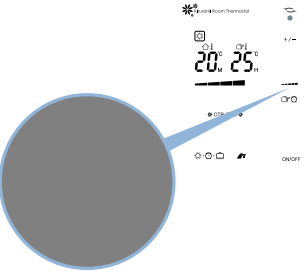
« » (CTR – 5700PLUS)

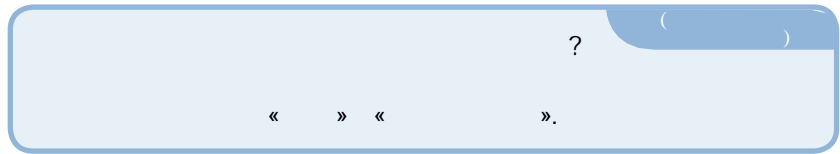
1. « », ( )  

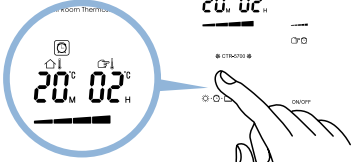
2. ( ) / ( ).  

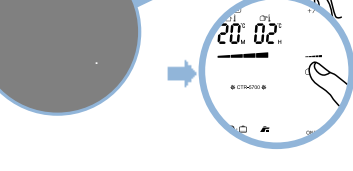
3. ( < < < < < < )  

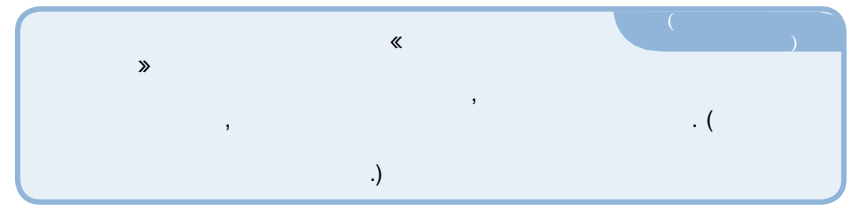

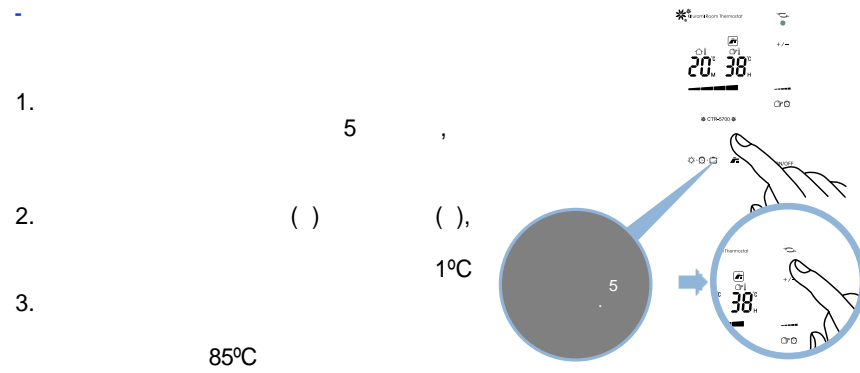
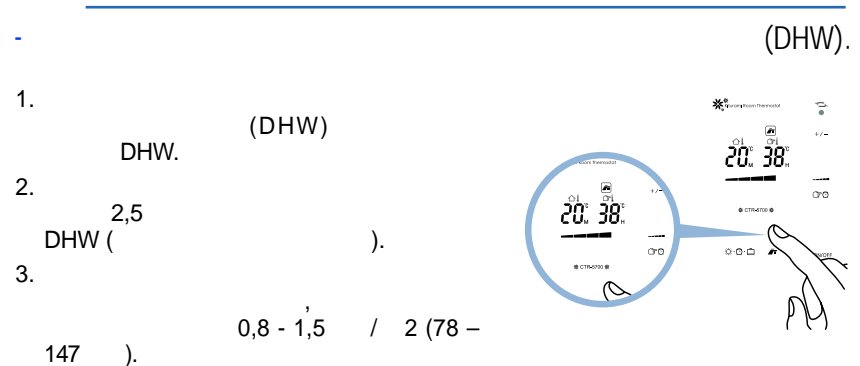
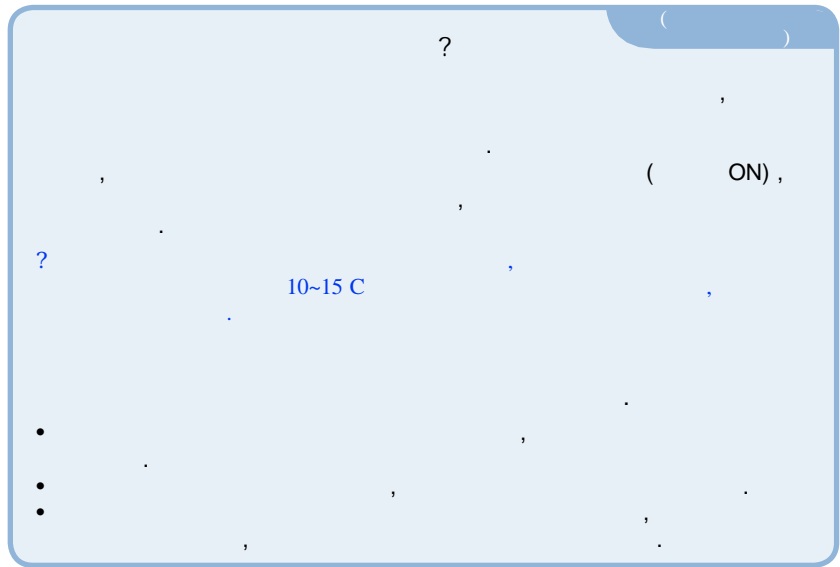
1. « », ( )  

2. ( ) / ( )  

3. ( ) / ( )  

4. ( ) / ( )









01 / 02 / 03

Restart (Power/

04

05

06

07

08 (10), / 230

95/98 ( ( ), )

96 ( . . . 15-16.)

97 ? (97), ( )



( )

5 ( )

«

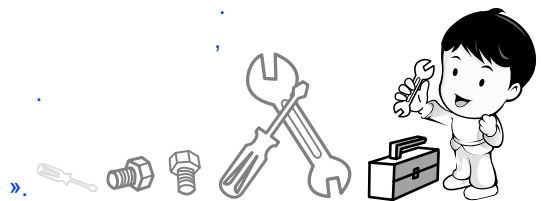

60 40

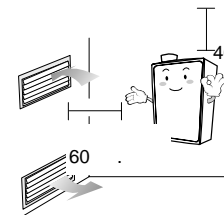

(CO).

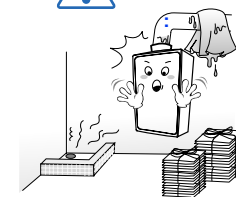

1

(CO)

30

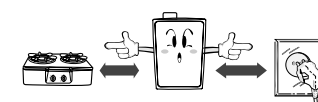

1

30

( )



31æ1è°ü° Û  
3.Ä°°÷¿i ¼³Äi ±ÝÁö

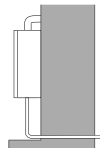

°Ö¿-¼° °®¿i ¼³Äi

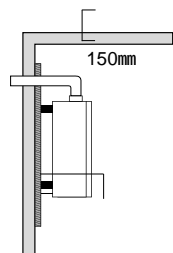

3

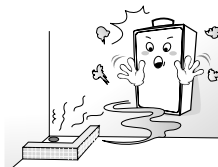

¿-¼°±â±ÜÄ³¼³Äi±ÝÁö

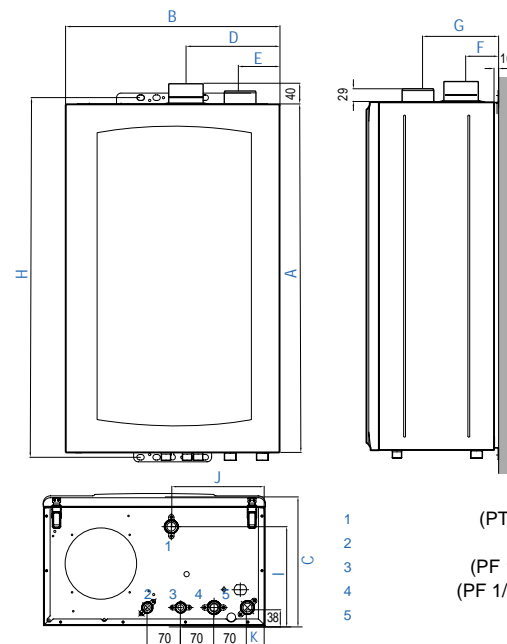

- 1 (PT 1/2")
- 2 (PF 3/4")
- 3 (PF 1/2")
- 4 (PF 1/2")
- 5 (PF 3/4")

[ 10 ~ 30 ]

房種	A	B	C	D	E	F	G	H	I	J	K
10, 13	720	430	232	197.9	86.4	75.6	147.6	746	181.5	215	26
16, 20	761	465	278	203.5	101	81.8	175.8	786	202.9	222.8	37
25, 30	787	505	305	203.8	109.6	97.4	208.9	813	227.7	272.6	37

35 ~ 45



-(FF)

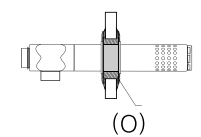
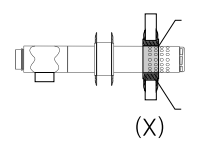
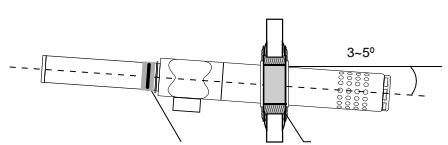
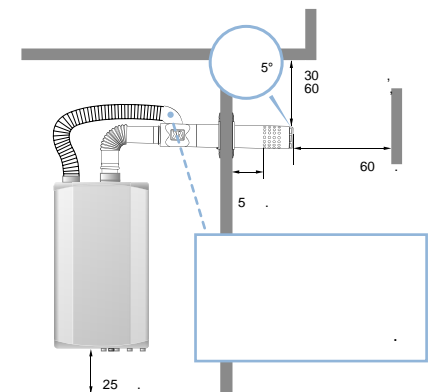

? ( FE)

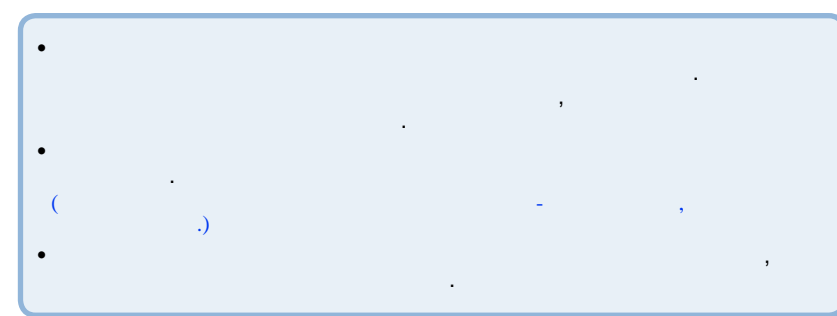
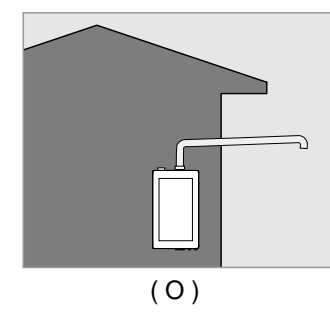
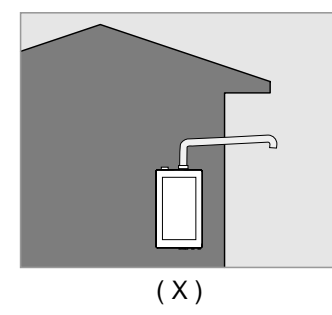





(FE)  
FE (Forced Exhaust – )

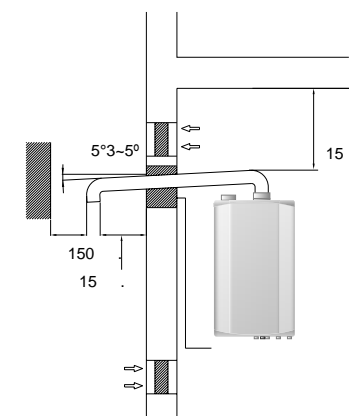

5°  
1,6  
60  
2  
FE  
90°  
(CO)  
!

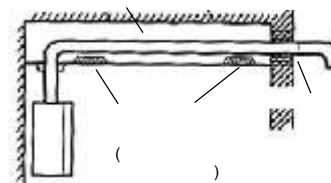
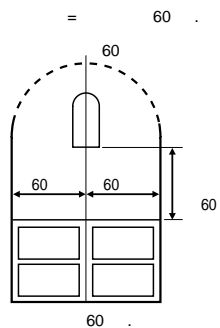

( )  
50  
50  
90  
20

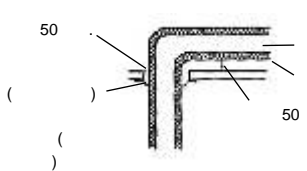



230 /50

230

230

230

1

30

30

30

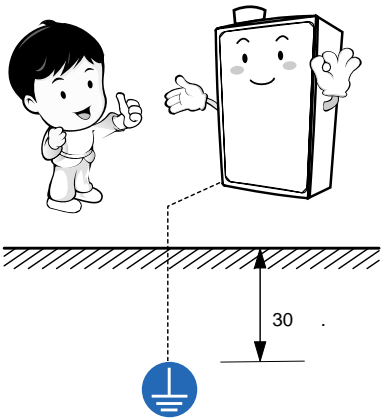

15A (PT 1/2).

(15A)

( 29),

30

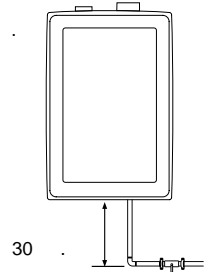

30

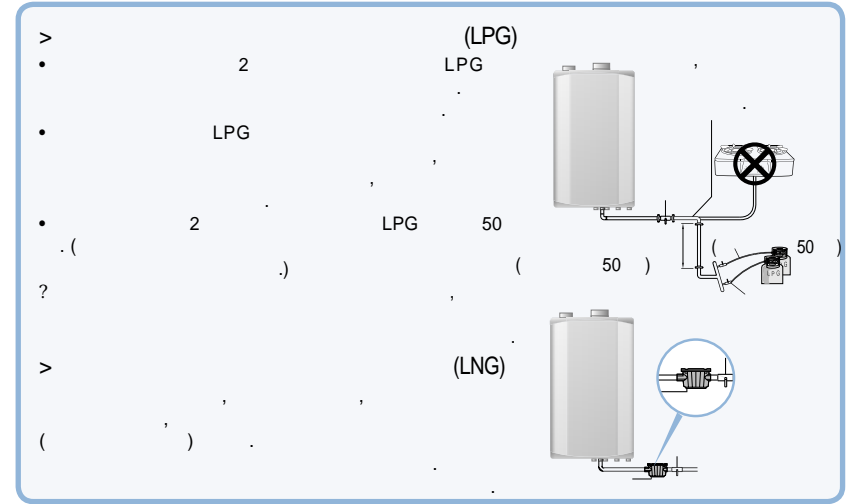

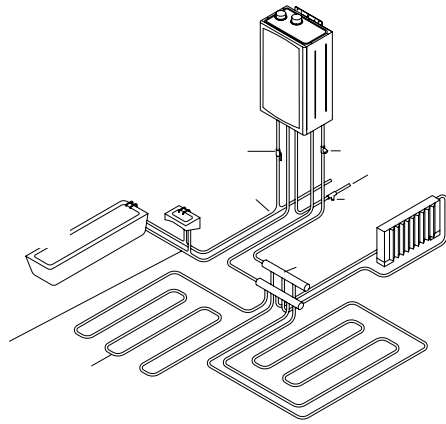

25K

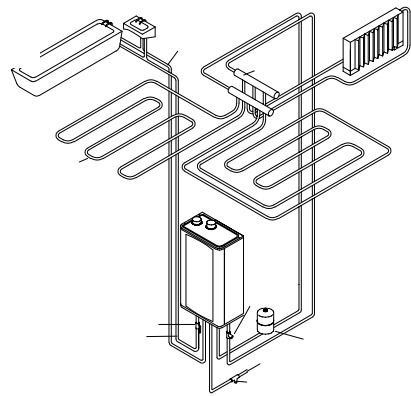

2.5 / 2.

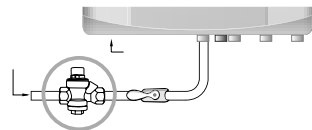

25

15A (PT 1/2)

1/100 ~ 1/200



15A (PT 1/2)



20A (PF 3/4).

36

44

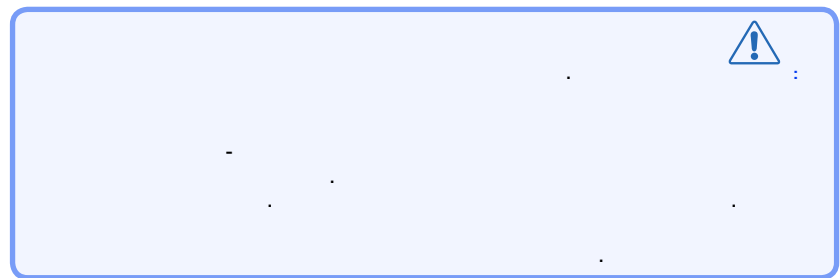

$$A = Q \times 0.6 \times K \times P$$

A: (mm<sup>2</sup>)  
 Q: ( / )  
 K: [ 1 ]  
 F: [ 2 ]  
 P: (mm<sup>2</sup>)

1.0	1.3	1.4
-----	-----	-----

[ 2 ]

	1	2	3	4	5	6	7	8	9	10	11	12	13	14	15	16	17	18	19	20	21
(F)	1.00	1.00	1.00	0.95	0.92	0.89	0.86	0.84	0.82	0.81	0.80	0.80	0.80	0.79	0.79	0.78	0.78	0.77	0.76	0.76	0.75

1:1.4

W:D

2

MOCIE, 08. 1998.



1

1.2 ~ 1.5

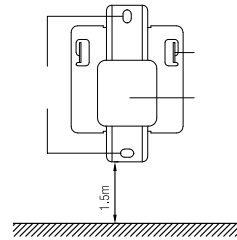

2

(CTR-5700PLUS).

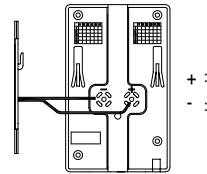

3

(CTR-5700PLUS)

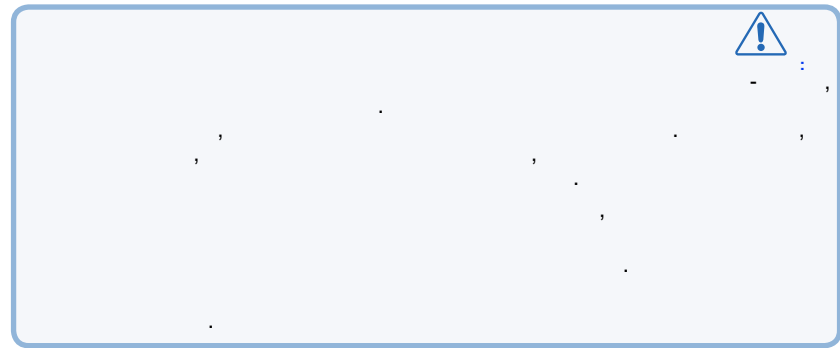
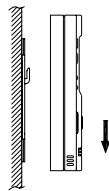

?

?

?

?

?

?

?

230 /50 ?

?

?

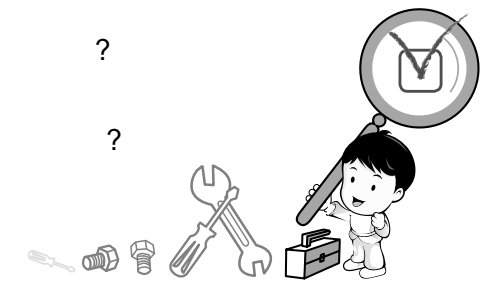

1. 2. 3. 4. 5. 6. 7. 8.

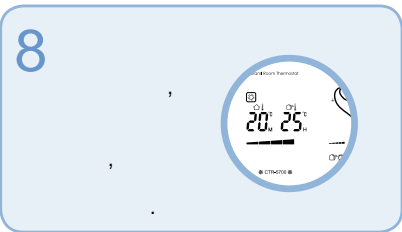
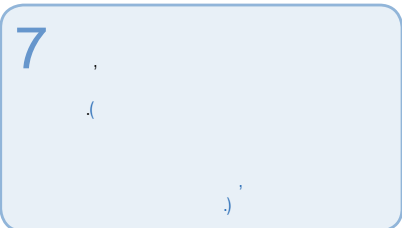
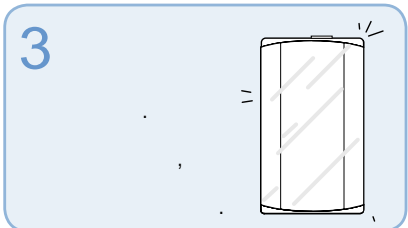
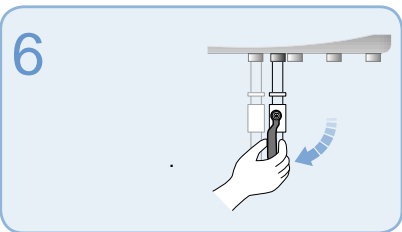
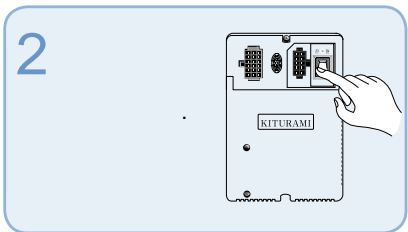
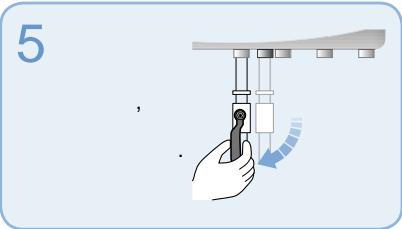

O

		WORLD PLUS-13		WORLD PLUS-16		WORLD PLUS-20		WORLD PLUS-25		WORLD PLUS-30					
		/		13,000		16,000		20,000		25,000		30,000			
		15.1		18.6		23.2		29.1		34.9					
												(FF)		(FE)	
		LNG	LPG	LNG	LPG	LNG	LPG	LNG	LPG	LNG	LPG	LNG	LPG		
		2.0±0.5	2.8 ±0.5	2.0±0.5	2.8 ±0.5	2.0±0.5	2.8 ±0.5	2.0±0.5	2.8 ±0.5	2.0±0.5	2.8 ±0.5	2.0±0.5	2.8 ±0.5		
		mm H <sub>2</sub> O	200±50	280±50	200±50	280±50	200±50	280±50	200±50	280±50	200±50	280±50	280±50		
		18.1		22.0		27.7		34.6		41.4					
		/	/	15,600	1.3	19,000	1.6	23,800	2.0	29,800	2.47	35,600	2.97		
		m <sup>2</sup>		0.55		0.65		0.78		0.98		1.14			
		(FF)		%		92.5		91.6		92.2		92.1		92.0	
		C		85											
		T=25 C	/	8.7		10.7		13.3		16.7		20.0			
		T=40 C	/	5.4		6.7		8.3		10.4		12.5			
		kPa(kgf/cm)		2.5											
		A	15 ( 1/2)												
		/	A	20 ( 3/4)											
		/	A	15 ( 1/2)											
		430 x 250 x 721		465 x 278 x 721				507 x 310 x 788							
		26		28		30		35		37					
		FE ( )		75 x 100											
		AC 230V X 50Hz (60Hz)													
		<ul style="list-style-type: none"> <li>•</li> <li>•</li> <li>•</li> <li>•</li> </ul>													

?



		WORLD PLUS-13	WORLD PLUS-16	WORLD PLUS-20	WORLD PLUS-25	WORLD PLUS-30
/		18.1(15,600)	22.0(19,000)	27.7(23,800)	34.6(29,800)	41.4(35,600)
/		15.1(13,000)	18.6(16,000)	23.2(20,000)	29.1(25,000)	34.9(35,000)
	%	92.5	91.6	92.2	92.1	92.0
	(mmH2O)	G20 / LNG : 20(200), LPG : 28(280)				
		2.5				
	C	85				
	C	45-85				
		7				
/		15.1(13,000)	18.6(16,000)	23.2(20,000)	29.1(25,000)	34.9(35,000)
		0.5				
		10				
	T=25 C ?t	8.7	10.7	13.3	16.7	20.0
	T=40 C ?t	5.4	6.7	8.3	10.4	12.5
/		230 / 50(60)				
/ /		B32-C12-C32-C42-C52-C62-C82				
		, 60/100				
	:	15 ( 1/2)				
	:	20 ( 3/4)				
	:	15 ( 1/2)				
( x ) x		430x250x721	465x278x721	507x310x788		
		33	34	34	39	39
		G20				

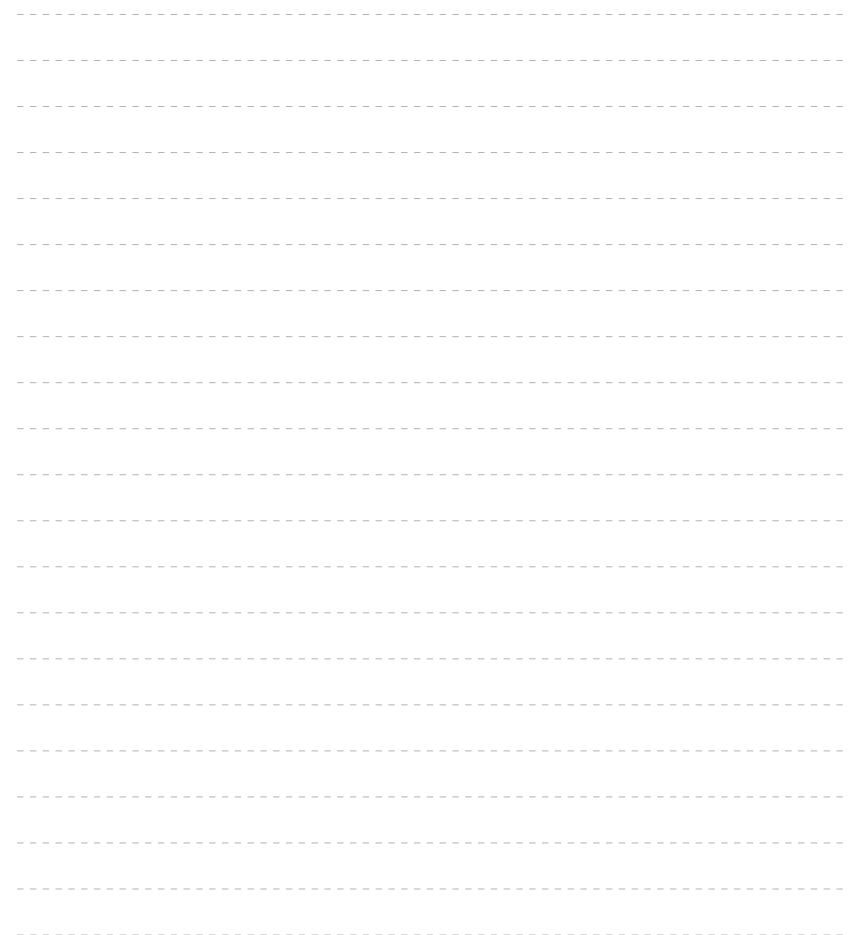



Kiturami

Kiturami



Kiturami

Kiturami